



### Operation condition

Insulation Resistance	250M min (at 500VDC)	Item 7 of IEC 60255-5
Dielectric Strength		
Between contacts	50Hz 750V	Item 6 of IEC 60255-5
Between contact and coil	50Hz 1500V	Item 6 of IEC 60255-5
Shock resistance	100m/s <sup>2</sup> 11ms	IEC 68-2-27 Test Ea
Vibration resistance	10Hz~55Hz double amplitude 1.5mm	IEC 68-2-6 Test Fc
Terminals strength	5N	IEC 68-2-21 Test Ua1
Solderability	260 5 5s 0.5s	IEC 68-2-20 Test Ta method 1
Ambient Temperature	-55 ~85	
Relative Humidity	85% (at 40 )	IEC 68-2-3 Test Ca
Mass	9.5g	

### Safety approvals

Safety approval	UL	VDE	CQC
Load	10A/250VAC,277VAC 85°C NO 12A/250VAC,277VAC 85°C NO	10A/250VAC 85°C NO 12A/250VAC 85°C NO	10A/250VAC 85°C NO 12A/250VAC 85°C NO

### Dimensions

mm /inch

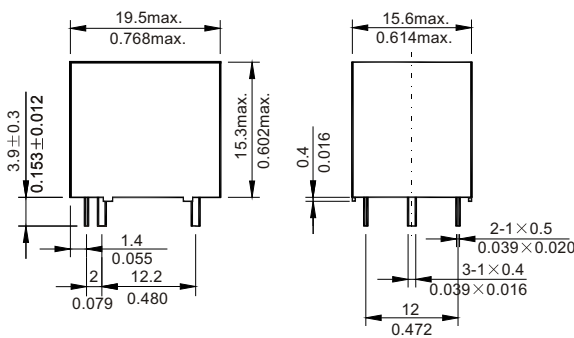

Dimensions

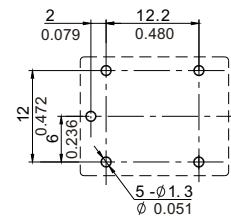

Mounting (Bottom view)

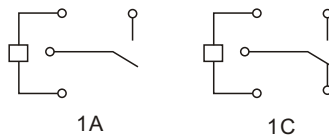

Wiring diagram(Bottom view)

NOTES 1).Dimensions are in millimeters.  
2).Inch equivalents are given for general information only.

### Reference Data

